

WARNINGS

Disconnect the electrical supply power at the service panel (fuse or circuit breaker box). Failure to comply could result in serious injury. Only qualified electricians should install this luminaire and the installation must conform to the applicable National Electrical Code and any local codes and ordinances. Make sure you have the proper tools and materials to complete the installation before attempting to install this luminaire. For supply connections, use wire rated for 90°C. This luminaire is not intended to be connected to a two-wire grounded supply. Luminaire must be grounded.

INSTALLATION

1. Remove the ceiling tile in the desired location for the fixture, and bring the supply conductors through the vacant grid position.
2. Remove the screws on the top of the Junction Box, and bring the supply wiring through the supply wiring through the desired knockout.
3. Connect the supply wiring to the wiring terminal block (Green to Ground, Black to Line, White to Neutral).
4. Connect the dimmer wiring to the wiring terminal block.

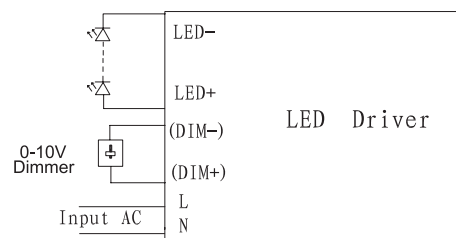
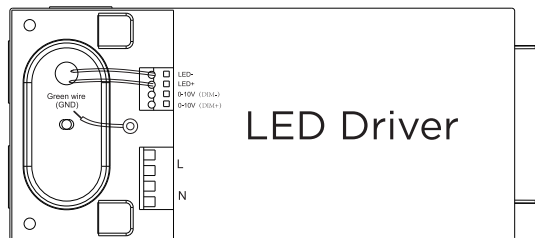

Wiring Diagram

5. Pass the supply wiring through the board mounted strain relief, and tighten the screws.
6. Tighten the junction box connector (not included) to affix the supply wiring to the exterior of the junction box.
7. Reattach the Junction Box cover using the provided screws.

INSTALLATION

Recessed Mounting

1. Bend all the hand buckles by 90° making it vertical to the rear of the fixture
Note: Clip is used for positioning not for mounting.

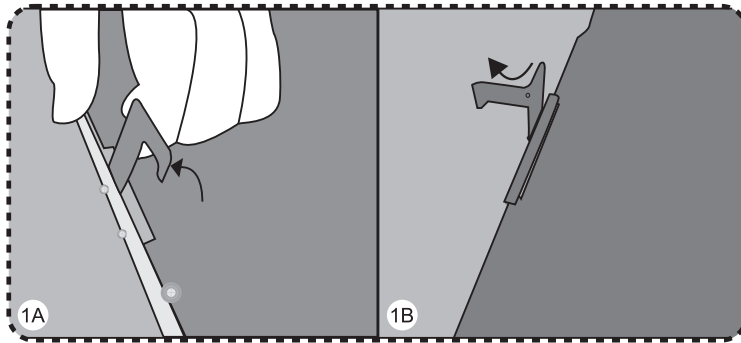

2. Slide panel back through open grid position.

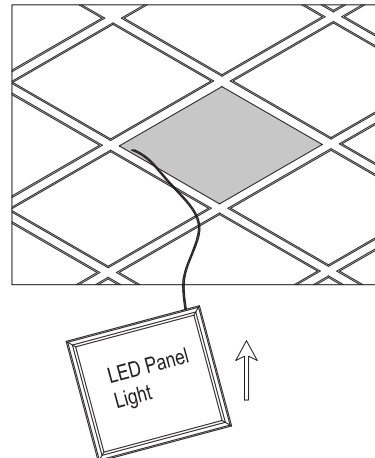
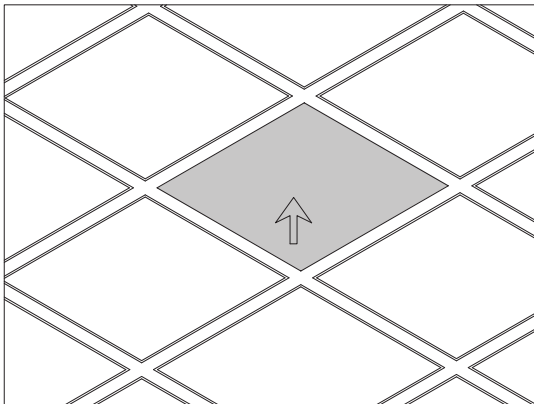

3. Lay panel flat ensuring that all edges of the panel contact the grid, and that the panel is securely in place.

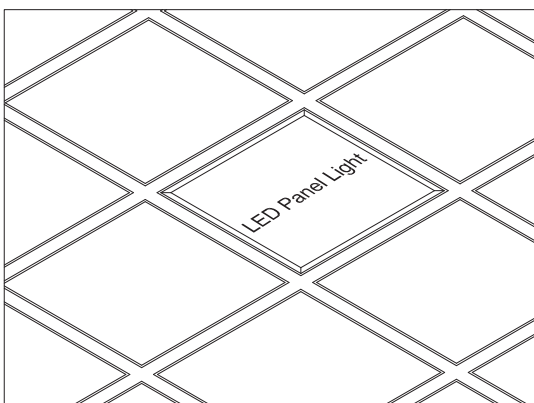

INSTALLATION

Surface Mounting

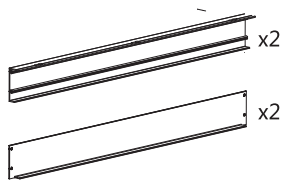

6 screws 8 screws 6 glue nails

1. Assemble 3 sides of the surface mount kit.

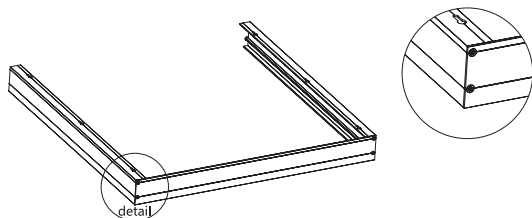

2. Fix the frame on the ceiling using screws provided, or your own hardware. Ensure that the hardware used is suitable for the substrate used.

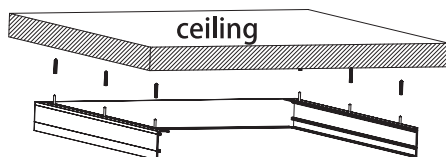

3. Slide LED Panel into frame.

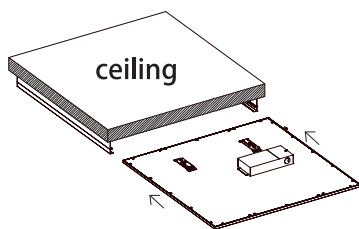

4. Attach last side of the surface mount kit using screws provided.

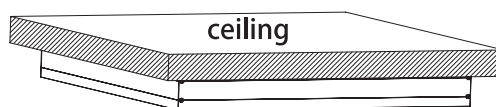
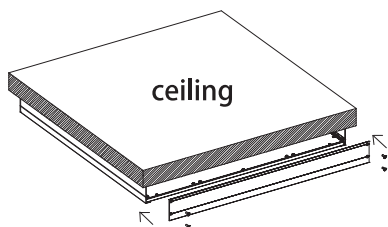

Note: Please make sure the frame is assembled well before being fixed onto the ceiling.

INSTALLATION

Suspension Mounting

1. Fix the suspension wire fixer on the ceiling.
2. Put suspending cable on the hooks.

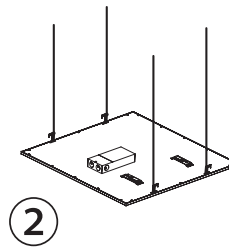
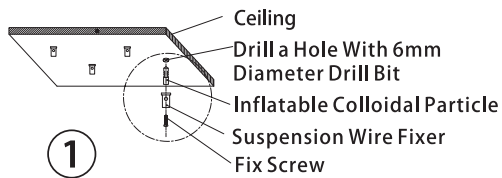

3. Fix the suspension wire on the ceiling.
4. Connect input wire 120-277V / 347V

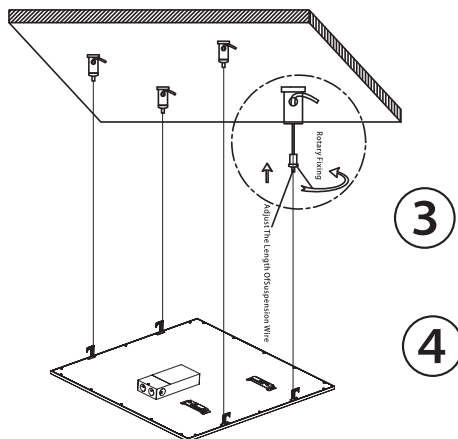

INSTALLATION

Emergency Backup

1. Slide the Emergency BU Kit into the bracket and push the clip on the bracket towards the bottom.

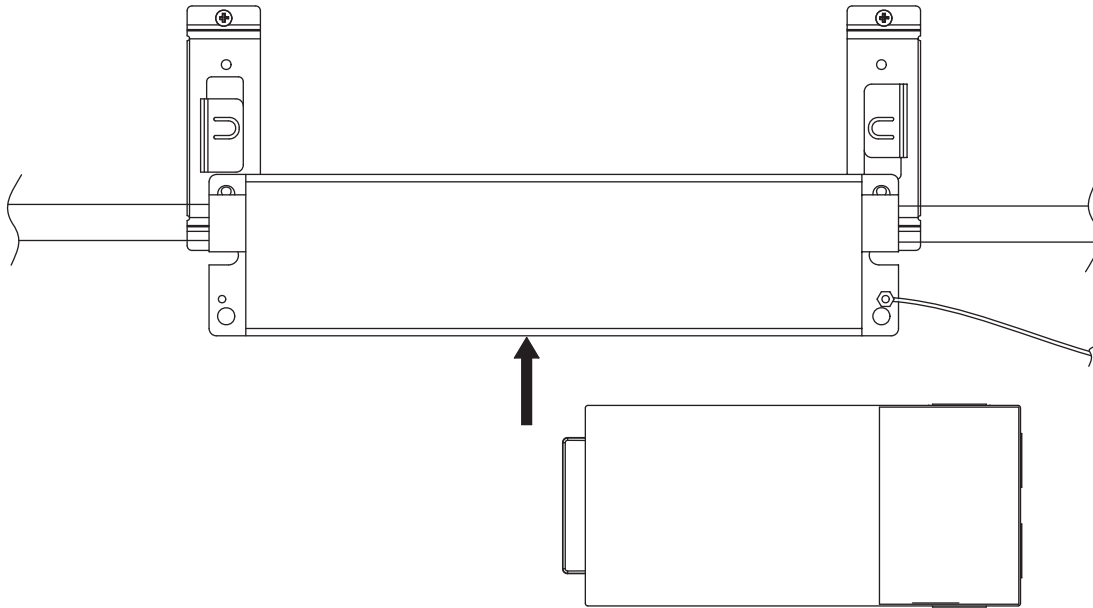

2. Screw on one side of the bracket before connecting conduit to the driver.

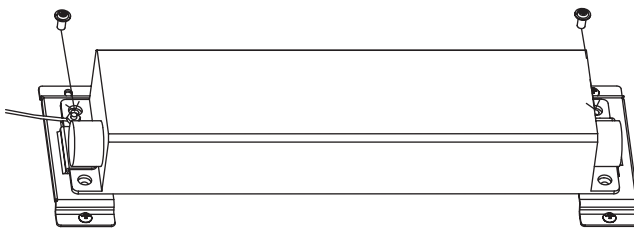

3. Connect conduit to the driver.

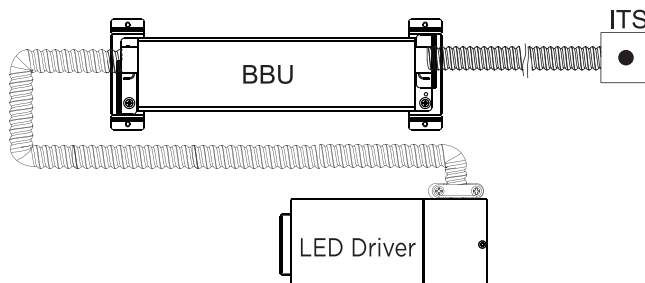

INSTALLATION

Emergency Battery Backup Option Wiring Diagram

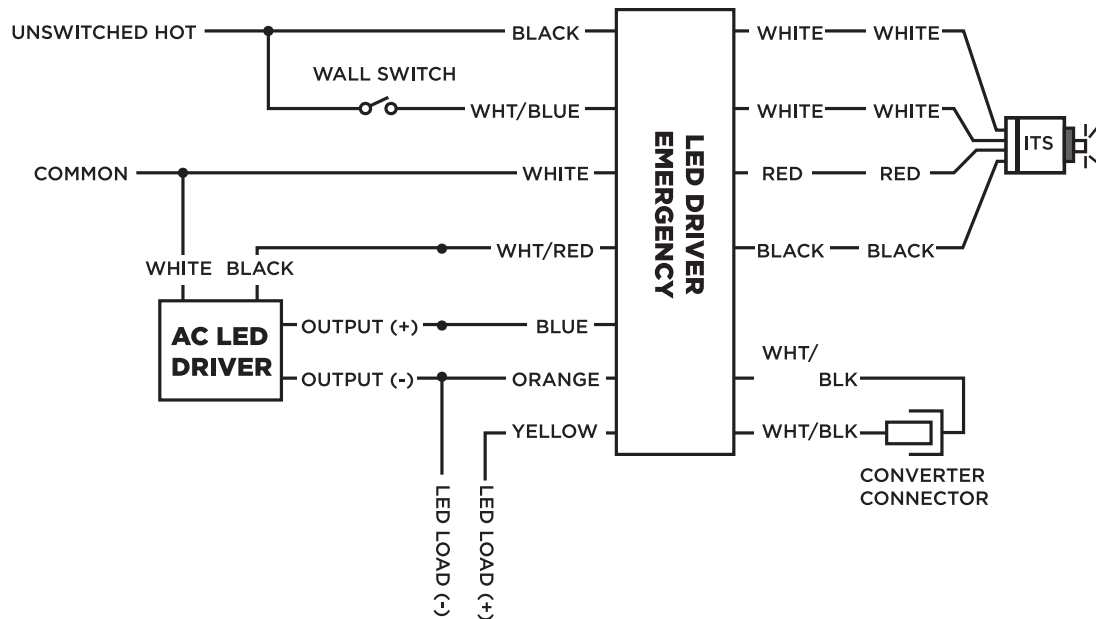

COMMISSIONING

Once installed please ensure that the luminaire is firmly fixed via the method used, and ensure that the wires are connected correctly before energizing the supply conductors.

Turn the power on, and check to ensure the luminaire works as intended. If not, de-energize and check connections, and contact your local dealer.

TROUBLESHOOTING

If luminaire does not work upon completion of installation:

1. Check your power source for connectivity, and correct voltage.
2. Check the electrical connections of the luminaire to the power source.
3. Check to ensure luminaire is grounded.
4. Ensure LED Driver is connected to luminaire wiring.

If luminaire still does not work, please call TamLite Lighting, or your local point of sale.